

# A47 Wansford to Sutton Dualling

**Scheme Number: TR010039**

## **Volume 2** **2.4 Rights of Way and Access Plans**

APFP Regulation 5(2)(k) and 5(2)(o)

Planning Act 2008

Infrastructure Planning (Applications: Prescribed  
Forms and Procedure) Regulations 2009

November~~June~~ 2021

Infrastructure Planning

Planning Act 2008

**The Infrastructure Planning  
(Applications: Prescribed Forms and  
Procedure) Regulations 2009**

**A47 Wansford to Sutton Dualling  
Development Consent Order 202[x]**

---

**2.4 RIGHTS OF WAY AND ACCESS PLANS**

---

<b>Regulation Number:</b>	Regulation 5(2)(k) and 5(2)(o)
<b>Planning Inspectorate Scheme Reference</b>	TR010039
<b>Application Document Reference</b>	TR010039/APP/2.4
<b>BIM Document Reference</b>	HE551494-GTY-LSI-000-RP-TX-30014
<b>Author:</b>	A47 Wansford to Sutton Dualling Project Team, Highways England

<b>Version</b>	<b>Date</b>	<b>Status of Version</b>
Rev 0	June 2021	Application Issue
<u>Rev 1</u>	<u>August 2021</u>	<u>Updated following PINS advice</u>
<u>Rev 2</u>	<u>November 2021</u>	<u>Updated following PINS advice</u>

## CONTENTS

1	<b>INTRODUCTION.....</b>	<b><del>1</del></b>
1.1	Purpose of this Document.....	<del>1</del>
2	<b>SCHEDULE OF PLANS INCLUDED IN THIS APPLICATION DOCUMENT .....</b>	<b>2</b>

## 1 INTRODUCTION

### 1.1 Purpose of this Document

- 1.1.1 These Rights of Way and Access Plans (these “Plans”) relate to an application made by Highways England (the “Applicant”) to the Secretary of State for Transport, via the Planning Inspectorate (the “Inspectorate”) under the Planning Act 2008 (the “2008 Act”) for a Development Consent Order (DCO). If made, the DCO would grant consent for the Wansford to Sutton Scheme (the “Scheme”).
- 1.1.2 The Scheme comprises the alteration of an existing highway by way of an upgrade to an existing 2.6km of single carriageway between Wansford to Sutton. It will create a new dual carriageway, to improve traffic flow and reduce congestion on the route. A detailed description of the Scheme can be found in Chapter 2: The Proposed Scheme of the Environmental Statement (ES) (**TR010039/APP/6.1**). These Plans cover the Scheme in its entirety.
- 1.1.3 These Plans comprise part of a suite of application documentation and are included in the application in compliance with Regulations 5(2)(k) and 5(2)(o) of the Infrastructure Planning (Prescribed Forms and Procedure) Regulations 2009 which requires:
- 5(2)(k) “where applicable, a plan identifying any new or altered means of access, stopping up of streets or roads or any diversions, extinguishments or creation of rights of way or public rights of navigation”*
- 5(2)(o) “any other plans, drawings and sections necessary to describe the proposals for which development consent is sought, showing details of design, external appearance, and the preferred layout of buildings and structures, drainage, surface water management, means of vehicular and pedestrian access, any car parking to be provided and means of landscaping”.*
- 1.1.4 These Plans also contain a key plan in order to comply with Regulation 5(4) of the 2009 Regulations which states:
- “Where a plan comprises three or more separate sheets a key plan must be provided showing the relationship between the different sheets.”*
- 1.1.5 As these Plans are part of the application documentation, they should be read alongside and informed by the other application documents. In particular, the Plans should be read alongside Schedule 3 and 4 of the draft DCO (**TR010039/APP/3.1**) (the plans show Part 6 of Schedule 3 and Parts 1-5 of Schedule 4).

## 2 SCHEDULE OF PLANS INCLUDED IN THIS APPLICATION DOCUMENT

Drawing Title	DCO Document Number	Drawing Number	Revision
Rights of Way and Access Plans - Regulation 5(2)(k) and 5(2)(o) Sheet 1 of 7	TR010039/APP/2.4 /1of7	HE551494-GTY-HKF-000-DR-CH-31001	<del>C02P01</del>
Rights of Way and Access Plans - Regulation 5(2)(k) and 5(2)(o) Sheet 2 of 7	TR010039/APP/2.4 /2of7	HE551494-GTY-HKF-000-DR-CH-31002	<del>C02P01</del>
Rights of Way and Access Plans - Regulation 5(2)(k) and 5(2)(o) Sheet 3 of 7	TR010039/APP/2.4 /3of7	HE551494-GTY-HKF-000-DR-CH-31003	<del>C02P01</del>
Rights of Way and Access Plans - Regulation 5(2)(k) and 5(2)(o) Sheet 4 of 7	TR010039/APP/2.4 /4of7	HE551494-GTY-HKF-000-DR-CH-31004	<del>P031</del>
Rights of Way and Access Plans - Regulation 5(2)(k) and 5(2)(o) Sheet 5 of 7	TR010039/APP/2.4 /5of7	HE551494-GTY-HKF-000-DR-CH-31005	<del>C02P01</del>
Rights of Way and Access Plans - Regulation 5(2)(k) and 5(2)(o) Sheet 6 of 7	TR010039/APP/2.4 /6of7	HE551494-GTY-HKF-000-DR-CH-31006	<del>P031</del>
Rights of Way and Access Plans - Regulation 5(2)(k) and 5(2)(o) Sheet 7 of 7	TR010039/APP/2.4 /7of7	HE551494-GTY-HKF-000-DR-CH-31007	<del>C02P01</del>
Rights of Way and Access Plans - Regulation 5(2)(k) and 5(2)(o) Key Plan	TR010039/APP/2.4 <del>/7of7</del>	HE551494-GTY-HGN-000-DR-CH-35008	<del>C02P01</del>

This drawing should not be relied on or used in circumstances other than those for which it was originally prepared and for which Sweco UK Ltd was commissioned. Sweco UK Ltd accepts no responsibility for this drawing to any party other than the person by whom it was commissioned. This drawing has been prepared on behalf of Galliford Try by Sweco UK Ltd for the titled project or named part thereof and should not be relied upon or used for any other project without an independent check being carried out as to its suitability and prior written authority of Galliford Try being obtained. Sweco UK Ltd accepts no responsibility or liability for the consequences of this drawing being used for a purpose other than the purposes for which it was commissioned. Any person using or relying on this drawing for such other purpose agrees, and will by such use or reliance be taken to confirm his/her agreement, to indemnify Sweco UK Ltd for all loss or damage resulting therefrom.

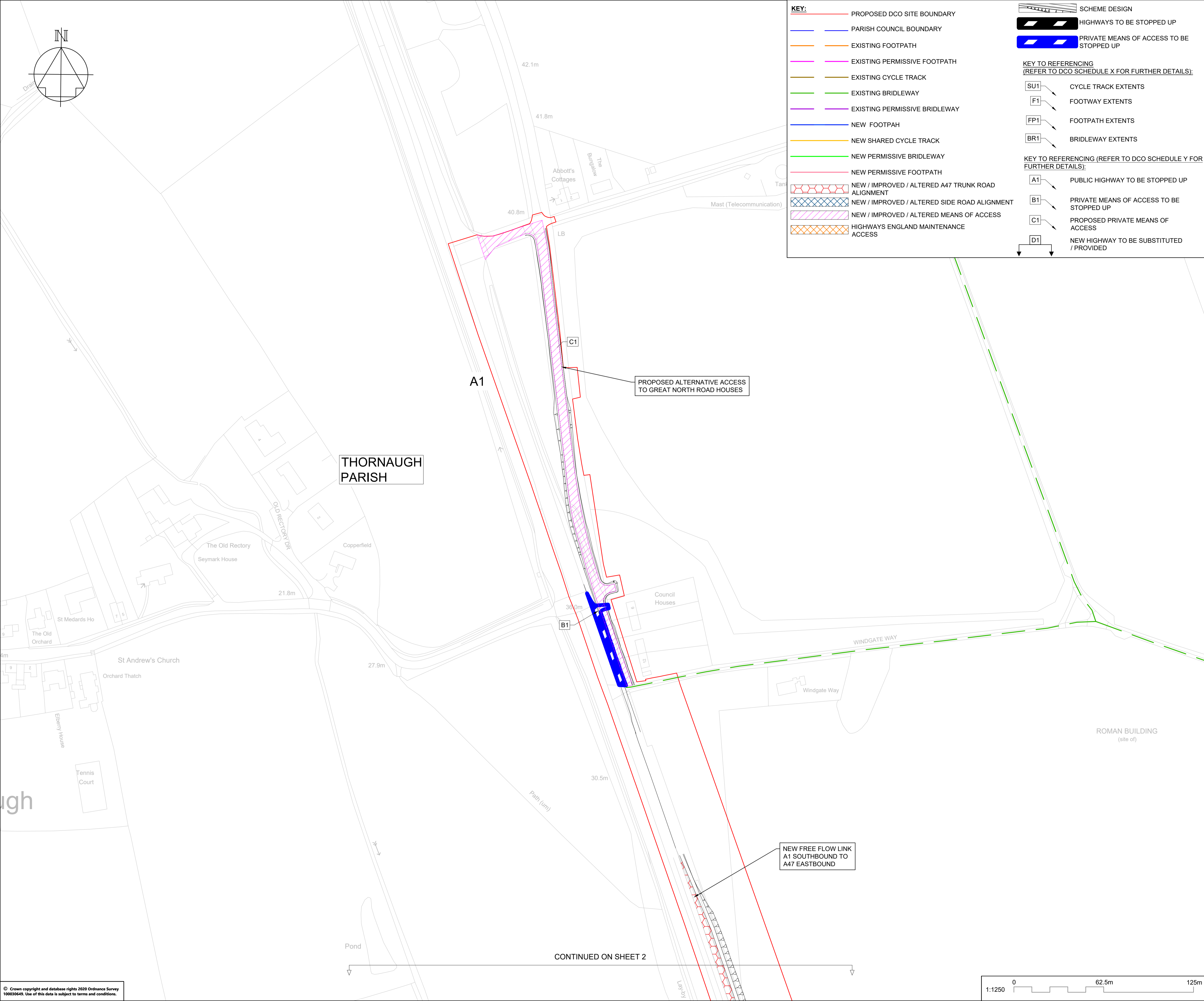

**KEY:**

- PROPOSED DCO SITE BOUNDARY
- PARISH COUNCIL BOUNDARY
- EXISTING FOOTPATH
- EXISTING PERMISSIVE FOOTPATH
- EXISTING CYCLE TRACK
- EXISTING BRIDLEWAY
- EXISTING PERMISSIVE BRIDLEWAY
- NEW FOOTPAH
- NEW SHARED CYCLE TRACK
- NEW PERMISSIVE BRIDLEWAY
- NEW PERMISSIVE FOOTPATH
- NEW / IMPROVED / ALTERED A47 TRUNK ROAD ALIGNMENT
- NEW / IMPROVED / ALTERED SIDE ROAD ALIGNMENT
- NEW / IMPROVED / ALTERED MEANS OF ACCESS
- HIGHWAYS ENGLAND MAINTENANCE ACCESS

**SCHEME DESIGN**

- HIGHWAYS TO BE STOPPED UP
- PRIVATE MEANS OF ACCESS TO BE STOPPED UP

**KEY TO REFERENCING (REFER TO DCO SCHEDULE X FOR FURTHER DETAILS):**

- [SU1] CYCLE TRACK EXTENTS
- [F1] FOOTWAY EXTENTS
- [FP1] FOOTPATH EXTENTS
- [BR1] BRIDLEWAY EXTENTS

**KEY TO REFERENCING (REFER TO DCO SCHEDULE Y FOR FURTHER DETAILS):**

- [A1] PUBLIC HIGHWAY TO BE STOPPED UP
- [B1] PRIVATE MEANS OF ACCESS TO BE STOPPED UP
- [C1] PROPOSED PRIVATE MEANS OF ACCESS
- [D1] NEW HIGHWAY TO BE SUBSTITUTED / PROVIDED

**NOTES**

Purpose of use  
**FOR DCO SUBMISSION**

Development Consent Order Number / Document  
**TR010039/APP/2.4**

**SHEET PLAN**

SHEETS 1 - 7 (INCLUDES INSETS 3A, 5B AND 7C)

1  
2  
3  
3A  
4  
5  
5B  
6  
7  
7C

A47/A1 JUNCTION  
SACREWELL FARM UNDERBRIDGE  
WANSFORD RAILWAY UNDERPASS  
NEW ROUNDABOUT

1. THESE PLANS SHOULD BE READ IN CONJUNCTION WITH OTHER PLANS AND DOCUMENTS IN THE DEVELOPMENT CONSENT ORDER  
2. ALL DIMENSIONS ARE IN METRES UNLESS STATED OTHERWISE.

SEE PLAN FOR KEY

REV	DATE	REVISION NOTE	ORG	CHKD	APPD
P01	16/06/21	SGAR 3 ISSUE	CDye	AWoo	SCM
C01	16/06/21	SGAR 3 ISSUE	CDye	AWoo	SCM
P02	01/07/21	DCO ISSUE	CDye	AWoo	SCM
C02	01/07/21	DCO ISSUE	CDye	AWoo	SCM

DESIGNER

**SWECO**

CONTRACTOR

**GallifordTry**

CLIENT

**highways  
england**

PROJECT TITLE

**A47 WANSFORD TO SUTTON DUALLING**

PROJECT STAGE

**PCF STAGE 3**

DRAWING TITLE

**RIGHTS OF WAY AND ACCESS PLANS  
REGULATION 5(2)(k) and 5(2)(o)  
SHEET 1 OF 7**

SUITABILITY

**AUTHORISED AS STAGE 3 COMPLETED**

SHEET SIZE	SCALE	STATUS	REVISION
A1	1:1250	A3	C02

DRAWING NUMBER

**HE551494-GTY-HKF-000-DR-CH-31001**

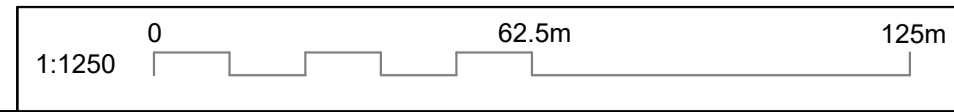

CONTINUED ON SHEET 2

This drawing should not be relied on or used in circumstances other than those for which it was originally prepared and for which Sweco UK Ltd was commissioned. Sweco UK Ltd accepts no responsibility for this drawing to any party other than the person by whom it was commissioned. This drawing has been prepared on behalf of Galliford Try by Sweco UK Ltd for the titled project or named part thereof and should not be relied upon or used for any other project without an independent check being carried out as to its suitability and prior written authority of Galliford Try being obtained. Sweco UK Ltd accepts no responsibility or liability for the consequences of this drawing being used for a purpose other than the purposes for which it was commissioned. Any person using or relying on this drawing for such other purpose agrees, and will by such use or reliance be taken to confirm his/her agreement, to indemnify Sweco UK Ltd for all loss or damage resulting therefrom.

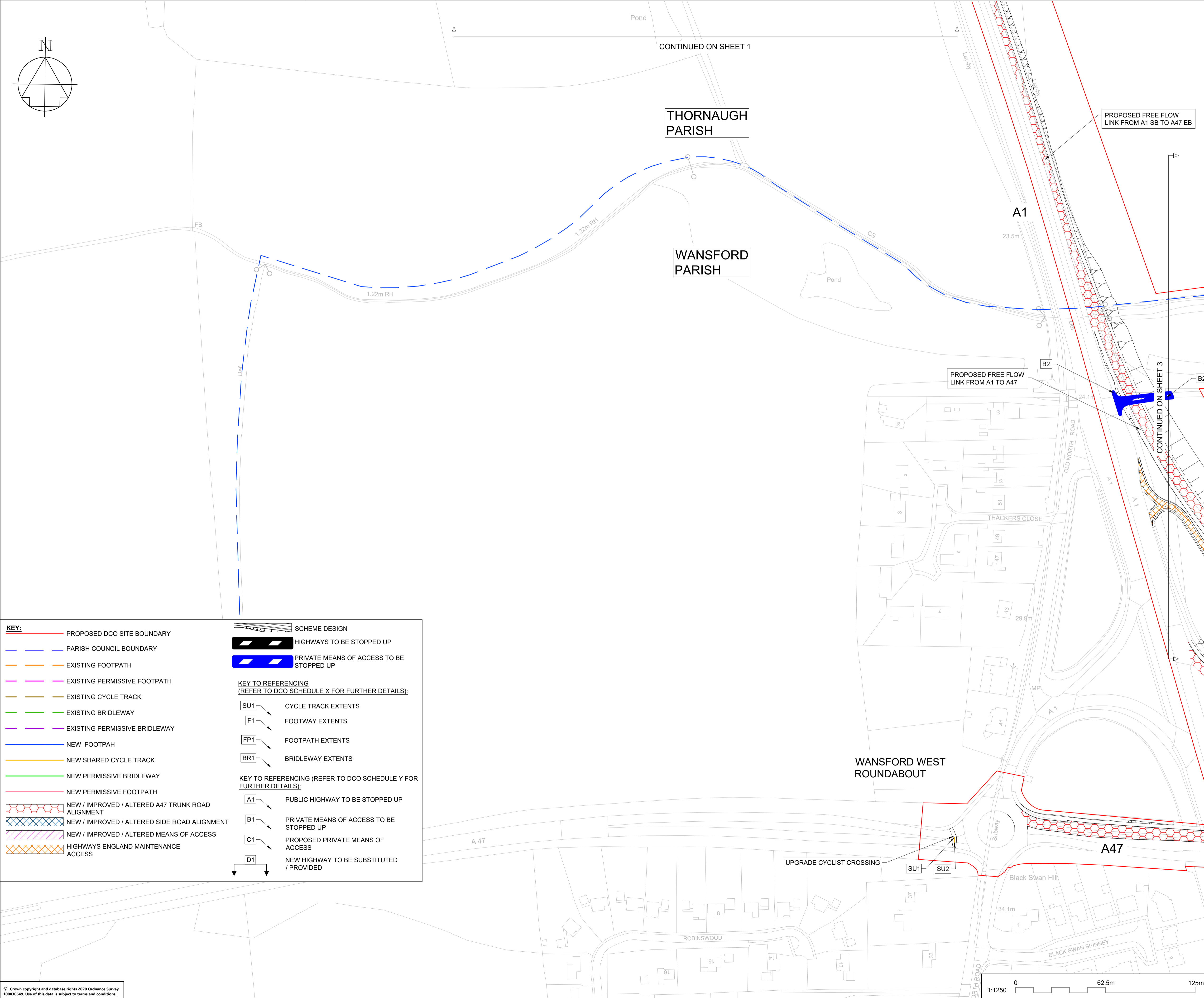
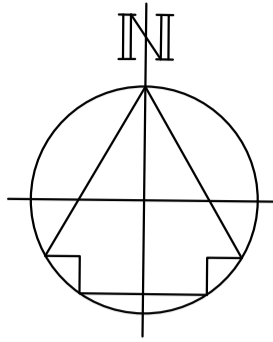

**KEY:**

- PROPOSED DCO SITE BOUNDARY
- PARISH COUNCIL BOUNDARY
- EXISTING FOOTPATH
- EXISTING PERMISSIVE FOOTPATH
- EXISTING CYCLE TRACK
- EXISTING BRIDLEWAY
- EXISTING PERMISSIVE BRIDLEWAY
- NEW FOOTPAH
- NEW SHARED CYCLE TRACK
- NEW PERMISSIVE BRIDLEWAY
- NEW PERMISSIVE FOOTPATH
- NEW / IMPROVED / ALTERED A47 TRUNK ROAD ALIGNMENT
- NEW / IMPROVED / ALTERED SIDE ROAD ALIGNMENT
- NEW / IMPROVED / ALTERED MEANS OF ACCESS
- HIGHWAYS ENGLAND MAINTENANCE ACCESS

**SCHEME DESIGN**

- HIGHWAYS TO BE STOPPED UP
- PRIVATE MEANS OF ACCESS TO BE STOPPED UP

**KEY TO REFERENCING (REFER TO DCO SCHEDULE X FOR FURTHER DETAILS):**

- SU1 CYCLE TRACK EXTENTS
- F1 FOOTWAY EXTENTS
- FP1 FOOTPATH EXTENTS
- BR1 BRIDLEWAY EXTENTS

**KEY TO REFERENCING (REFER TO DCO SCHEDULE Y FOR FURTHER DETAILS):**

- A1 PUBLIC HIGHWAY TO BE STOPPED UP
- B1 PRIVATE MEANS OF ACCESS TO BE STOPPED UP
- C1 PROPOSED PRIVATE MEANS OF ACCESS
- D1 NEW HIGHWAY TO BE SUBSTITUTED / PROVIDED

**NOTES**

Purpose of use  
**FOR DCO SUBMISSION**

Development Consent Order Number / Document  
**TR010039/APP/2.4**

**SHEET PLAN**

SHEETS 1 - 7 (INCLUDES INSETS 3A, 5B AND 7C)

1. THESE PLANS SHOULD BE READ IN CONJUNCTION WITH OTHER PLANS AND DOCUMENTS IN THE DEVELOPMENT CONSENT ORDER.
2. ALL DIMENSIONS ARE IN METRES UNLESS STATED OTHERWISE.

SEE PLAN FOR KEY

REV	DATE	REVISION NOTE	ORG	CHKD	APPD
P01	16/06/21	SGAR 3 ISSUE	CDye	AWoo	SCM
C01	16/06/21	SGAR 3 ISSUE	CDye	AWoo	SCM
P02	01/07/21	DCO ISSUE	CDye	AWoo	SCM
C02	01/07/21	DCO ISSUE	CDye	AWoo	SCM

DESIGNER

**SWECO**

CONTRACTOR

**GallifordTry**

CLIENT

**highways  
england**

PROJECT TITLE  
**A47 WANSFORD TO SUTTON DUALLING**

PROJECT STAGE  
**PCF STAGE 3**

DRAWING TITLE  
**RIGHTS OF WAY AND ACCESS PLANS  
REGULATION 5(2)(k) and 5(2)(o)  
SHEET 2 OF 7**

SUITABILITY  
**AUTHORISED AS STAGE 3 COMPLETED**

SHEET SIZE <b>A1</b>	SCALE <b>1:1250</b>	STATUS <b>A3</b>	REVISION <b>C02</b>
DRAWING NUMBER <b>HE551494-GTY-HKF-000-DR-CH-31002</b>			

This drawing should not be relied on or used in circumstances other than those for which it was originally prepared and for which Sweco UK Ltd was commissioned. Sweco UK Ltd accepts no responsibility for this drawing to any party other than the person by whom it was commissioned. This drawing has been prepared on behalf of Galliford Try by Sweco UK Ltd for the titled project or named part thereof and should not be relied upon or used for any other project without an independent check being carried out as to its suitability and prior written authority of Galliford Try being obtained. Sweco UK Ltd accepts no responsibility or liability for the consequences of this drawing being used for a purpose other than those for which it was commissioned. Any person using or relying on this drawing for such other purpose agrees, and will by such use or reliance be taken to confirm his/her agreement, to indemnify Sweco UK Ltd for all loss or damage resulting therefrom.

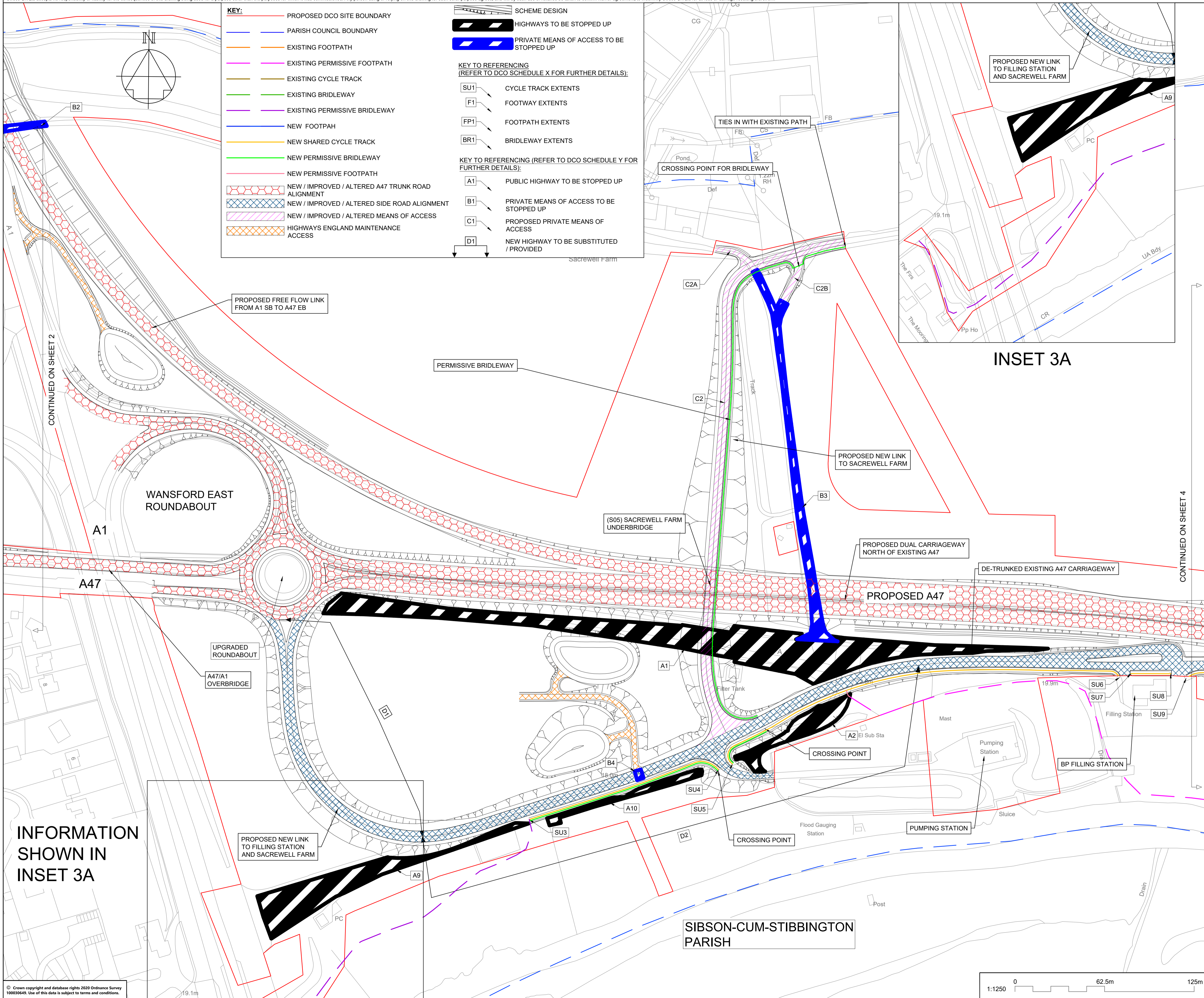

- KEY:**
- PROPOSED DCO SITE BOUNDARY
  - PARISH COUNCIL BOUNDARY
  - EXISTING FOOTPATH
  - EXISTING PERMISSIVE FOOTPATH
  - EXISTING CYCLE TRACK
  - EXISTING BRIDLEWAY
  - EXISTING PERMISSIVE BRIDLEWAY
  - NEW FOOTPAH
  - NEW SHARED CYCLE TRACK
  - NEW PERMISSIVE BRIDLEWAY
  - NEW PERMISSIVE FOOTPATH
  - NEW / IMPROVED / ALTERED A47 TRUNK ROAD ALIGNMENT
  - NEW / IMPROVED / ALTERED SIDE ROAD ALIGNMENT
  - NEW / IMPROVED / ALTERED MEANS OF ACCESS
  - HIGHWAYS ENGLAND MAINTENANCE ACCESS

- SCHEME DESIGN**
- HIGHWAYS TO BE STOPPED UP
  - PRIVATE MEANS OF ACCESS TO BE STOPPED UP
- KEY TO REFERENCING (REFER TO DCO SCHEDULE X FOR FURTHER DETAILS):**
- SU1 CYCLE TRACK EXTENTS
  - F1 FOOTWAY EXTENTS
  - FP1 FOOTPATH EXTENTS
  - BR1 BRIDLEWAY EXTENTS
- KEY TO REFERENCING (REFER TO DCO SCHEDULE Y FOR FURTHER DETAILS):**
- A1 PUBLIC HIGHWAY TO BE STOPPED UP
  - B1 PRIVATE MEANS OF ACCESS TO BE STOPPED UP
  - C1 PROPOSED PRIVATE MEANS OF ACCESS
  - D1 NEW HIGHWAY TO BE SUBSTITUTED / PROVIDED

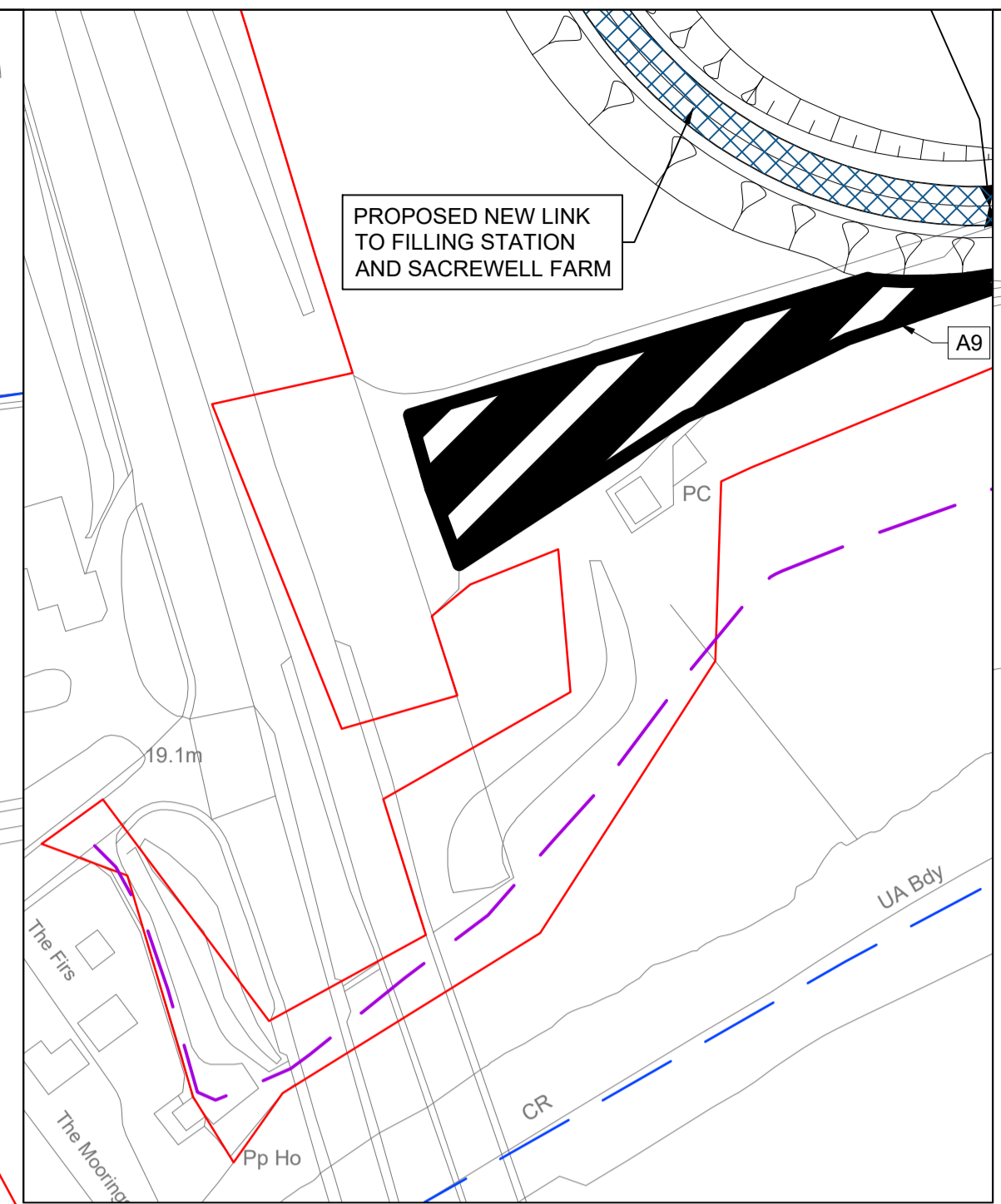

**NOTES**

Purpose of use  
**FOR DCO SUBMISSION**

Development Consent Order Number / Document  
**TR010039/APP/2.4**

**SHEET PLAN**

SHEETS 1 - 7 (INCLUDES INSETS 3A, 5B AND 7C)

WANSFORD RAILWAY UNDERPASS  
5B  
A47/A1 JUNCTION  
3A  
SACREWELL FARM UNDERBRIDGE  
7C  
NEW ROUNDABOUT

- THESE PLANS SHOULD BE READ IN CONJUNCTION WITH OTHER PLANS AND DOCUMENTS IN THE DEVELOPMENT CONSENT ORDER
- ALL DIMENSIONS ARE IN METRES UNLESS STATED OTHERWISE.

SEE PLAN FOR KEY

REV	DATE	REVISION NOTE	ORG	CHKD	APPD
P01	16/06/21	SGAR 3 ISSUE	CDye	AWoo	SCM
C01	16/06/21	SGAR 3 ISSUE	CDye	AWoo	SCM
P02	01/07/21	DCO ISSUE	CDye	AWoo	SCM
C02	01/07/21	DCO ISSUE	CDye	AWoo	SCM

DESIGNER	CONTRACTOR	CLIENT	PROJECT TITLE	PROJECT STAGE	DRAWING TITLE	SUITABILITY
SWECO	GallifordTry	highways england	A47 WANSFORD TO SUTTON DUALLING	PCF STAGE 3	RIGHTS OF WAY AND ACCESS PLANS REGULATION 5(2)(k) and 5(2)(o) SHEET 3 OF 7	AUTHORISED AS STAGE 3 COMPLETED

**SWECO**

**GallifordTry**

**highways england**

**PROJECT TITLE**  
A47 WANSFORD TO SUTTON DUALLING

**PROJECT STAGE**  
PCF STAGE 3

**DRAWING TITLE**  
RIGHTS OF WAY AND ACCESS PLANS REGULATION 5(2)(k) and 5(2)(o) SHEET 3 OF 7

**SUITABILITY**  
AUTHORISED AS STAGE 3 COMPLETED

<b>SHEET SIZE</b> A1	<b>SCALE</b> 1:1250	<b>STATUS</b> A3	<b>REVISION</b> C02
-------------------------	------------------------	---------------------	------------------------

**DRAWING NUMBER**  
HE551494-GTY-HKF-000-DR-CH-31003

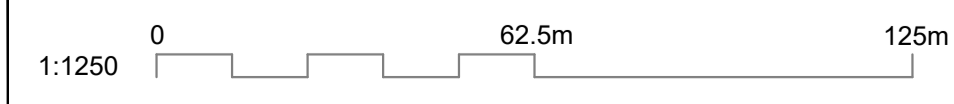



This drawing should not be relied on or used in circumstances other than those for which it was originally prepared and for which Sweco UK Ltd was commissioned. Sweco UK Ltd accepts no responsibility for this drawing to any party other than the person by whom it was commissioned. This drawing has been prepared on behalf of Galliford Try by Sweco UK Ltd for the titled project or named part thereof and should not be relied upon or used for any other project without an independent check being carried out as to its suitability and prior written authority of Galliford Try being obtained. Sweco UK Ltd accepts no responsibility or liability for the consequences of this drawing being used for a purpose other than the purposes for which it was commissioned. Any person using or relying on this drawing for such other purpose agrees, and will by such use or reliance be taken to confirm his/her agreement, to indemnify Sweco UK Ltd for all loss or damage resulting therefrom.

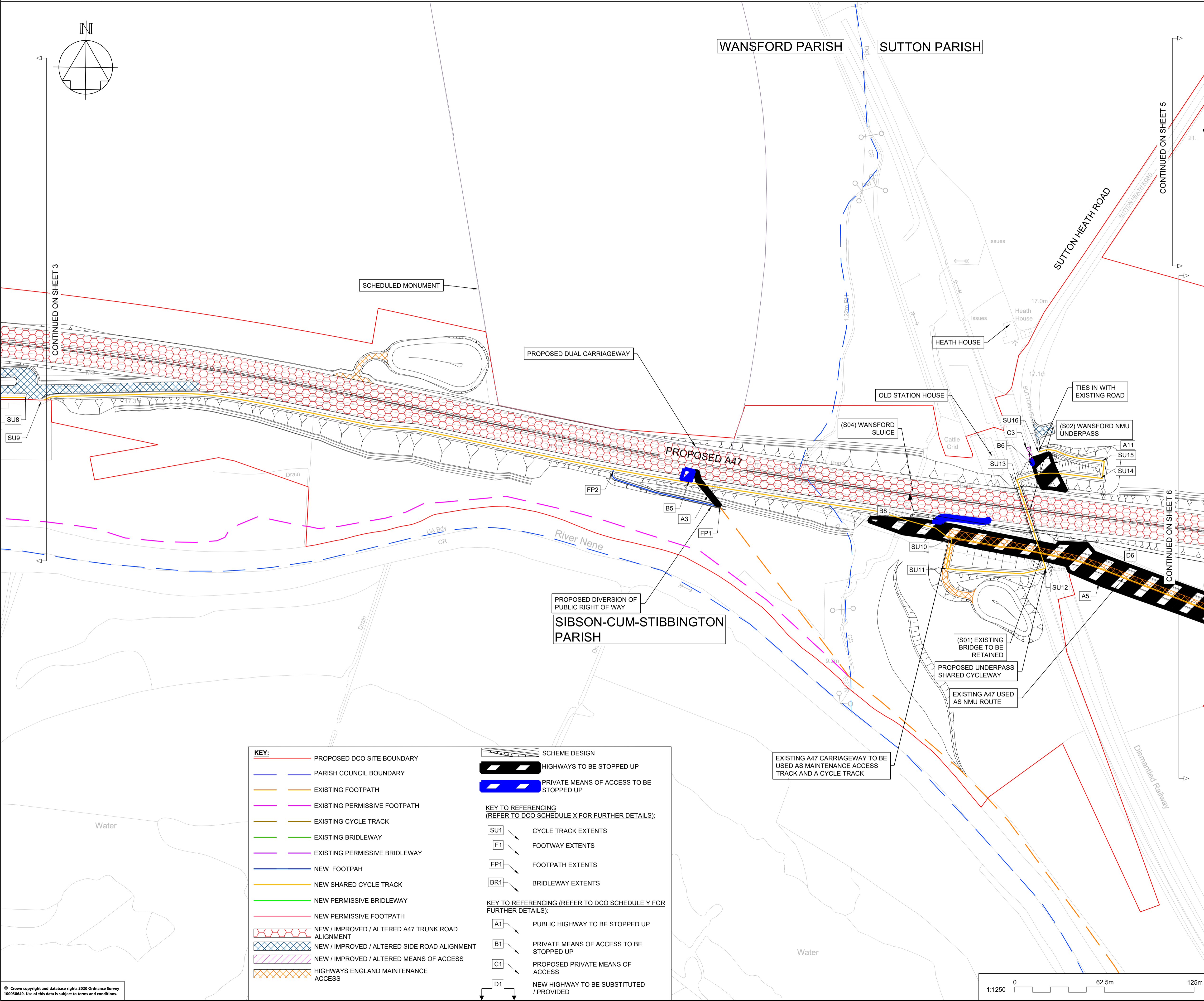

**NOTES**

Purpose of use  
**FOR DCO SUBMISSION**

Development Consent Order Number / Document  
**TR010039/APP/2.4**

**SHEET PLAN**  
SHEETS 1 - 7 (INCLUDES INSETS 3A, 5B AND 7C)  
WANSFORD RAILWAY UNDERPASS  
A47/A1 JUNCTION  
SACREWELL FARM UNDERBRIDGE  
NEW ROUNDABOUT

1. THESE PLANS SHOULD BE READ IN CONJUNCTION WITH OTHER PLANS AND DOCUMENTS IN THE DEVELOPMENT CONSENT ORDER.
2. ALL DIMENSIONS ARE IN METRES UNLESS STATED OTHERWISE.

SEE PLAN FOR KEY

REV	DATE	REVISION NOTE	ORG	CHKD	APPD
P01	16/06/21	SGAR 3 ISSUE	CDye	AWoo	SCM
C01	16/06/21	SGAR 3 ISSUE	CDye	AWoo	SCM
P02	01/07/21	DCO ISSUE	CDye	AWoo	SCM
C02	01/07/21	DCO ISSUE	CDye	AWoo	SCM
P03	06/08/21	DCO UPDATE	CDye	AWoo	SCM

DESIGNER  
**SWECO**

CONTRACTOR  
**GallifordTry**

CLIENT  
**highways england**

PROJECT TITLE  
**A47 WANSFORD TO SUTTON DUALLING**

PROJECT STAGE  
**PCF STAGE 3**

DRAWING TITLE  
**RIGHTS OF WAY AND ACCESS PLANS  
REGULATION 5(2)(k) and 5(2)(o)  
SHEET 4 OF 7**

SUITABILITY  
**SUITABLE FOR STAGE APPROVAL**

SHEET SIZE	SCALE	STATUS	REVISION
A1	1:1250	S4	P03

DRAWING NUMBER  
**HE551494-GTY-HKF-000-DR-CH-31004**

© Crown copyright and database rights 2020 Ordnance Survey 100019640. Use of this data is subject to terms and conditions.

This drawing should not be relied on or used in circumstances other than those for which it was originally prepared and for which Sweco UK Ltd was commissioned. Sweco UK Ltd accepts no responsibility for this drawing to any party other than the person by whom it was commissioned. This drawing has been prepared on behalf of Galliford Try by Sweco UK Ltd for the titled project or named part thereof and should not be relied upon or used for any other project without an independent check being carried out as to its suitability and prior written authority of Galliford Try being obtained. Sweco UK Ltd accepts no responsibility or liability for the consequences of this drawing being used for a purpose other than the purposes for which it was commissioned. Any person using or relying on this drawing for such other purpose agrees, and will by such use or reliance be taken to confirm his/her agreement, to indemnify Sweco UK Ltd for all loss or damage resulting therefrom.

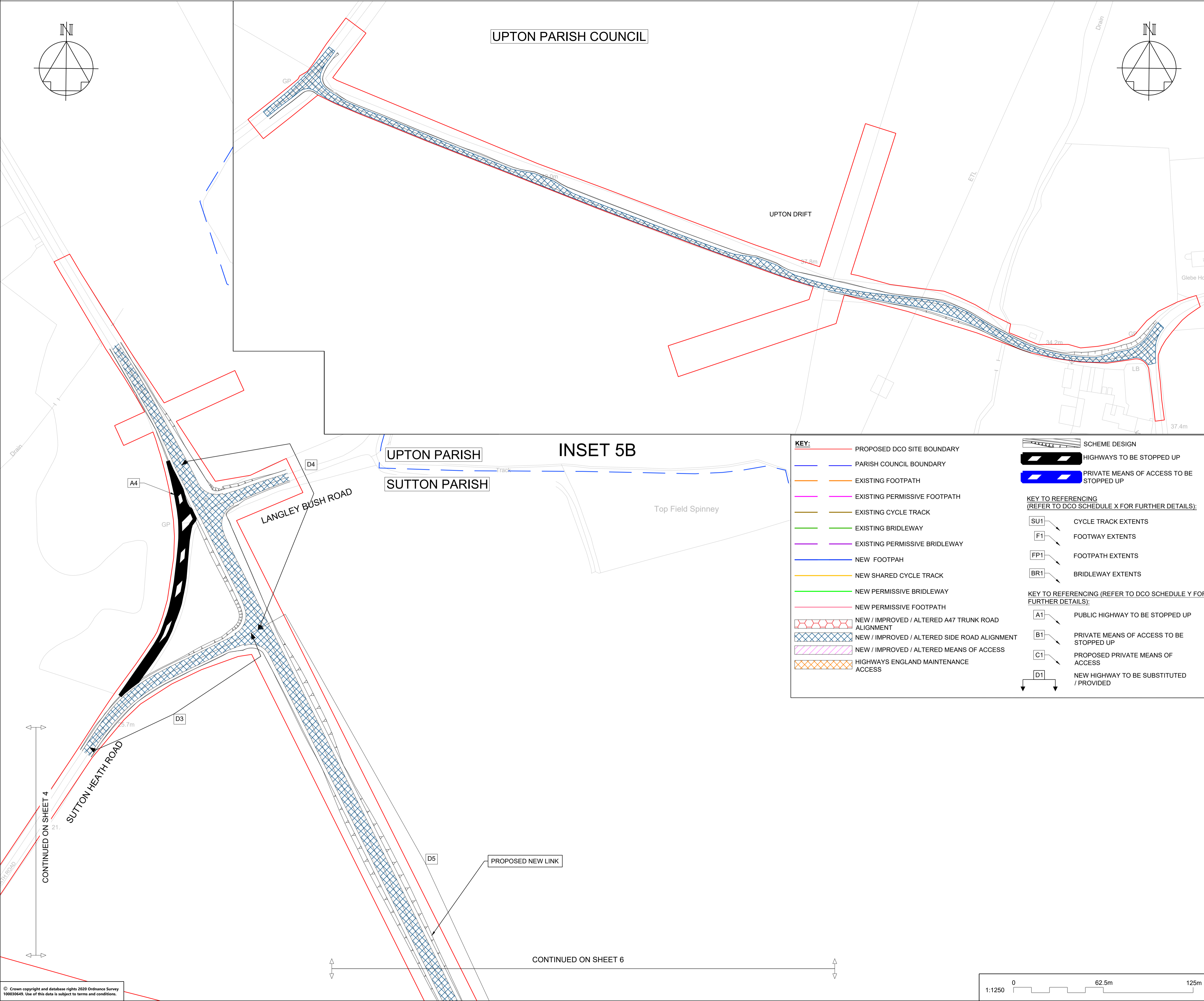

UPTON PARISH COUNCIL

UPTON PARISH  
SUTTON PARISH  
INSET 5B

**KEY:**

- PROPOSED DCO SITE BOUNDARY
- PARISH COUNCIL BOUNDARY
- EXISTING FOOTPATH
- EXISTING PERMISSIVE FOOTPATH
- EXISTING CYCLE TRACK
- EXISTING BRIDLEWAY
- EXISTING PERMISSIVE BRIDLEWAY
- NEW FOOTPAH
- NEW SHARED CYCLE TRACK
- NEW PERMISSIVE BRIDLEWAY
- NEW PERMISSIVE FOOTPATH
- NEW / IMPROVED / ALTERED A47 TRUNK ROAD ALIGNMENT
- NEW / IMPROVED / ALTERED SIDE ROAD ALIGNMENT
- NEW / IMPROVED / ALTERED MEANS OF ACCESS
- HIGHWAYS ENGLAND MAINTENANCE ACCESS

**SCHEME DESIGN**

- HIGHWAYS TO BE STOPPED UP
- PRIVATE MEANS OF ACCESS TO BE STOPPED UP

**KEY TO REFERENCING (REFER TO DCO SCHEDULE X FOR FURTHER DETAILS):**

- SU1 CYCLE TRACK EXTENTS
- F1 FOOTWAY EXTENTS
- FP1 FOOTPATH EXTENTS
- BR1 BRIDLEWAY EXTENTS

**KEY TO REFERENCING (REFER TO DCO SCHEDULE Y FOR FURTHER DETAILS):**

- A1 PUBLIC HIGHWAY TO BE STOPPED UP
- B1 PRIVATE MEANS OF ACCESS TO BE STOPPED UP
- C1 PROPOSED PRIVATE MEANS OF ACCESS
- D1 NEW HIGHWAY TO BE SUBSTITUTED / PROVIDED

**NOTES**

Purpose of use  
**FOR DCO SUBMISSION**

Development Consent Order Number / Document  
**TR010039/APP/2.4**

**SHEET PLAN**  
SHEETS 1 - 7 (INCLUDES INSETS 3A, 5B AND 7C).  
WANSFORD RAILWAY UNDERPASS 5B  
A47/A1 JUNCTION 3A  
SACREWELL FARM UNDERBRIDGE 7C  
NEW ROUNDABOUT 6

1. THESE PLANS SHOULD BE READ IN CONJUNCTION WITH OTHER PLANS AND DOCUMENTS IN THE DEVELOPMENT CONSENT ORDER.
2. ALL DIMENSIONS ARE IN METRES UNLESS STATED OTHERWISE.

SEE PLAN FOR KEY

REV	DATE	REVISION NOTE	ORG	CHKD	APPD
P01	16/06/21	SGAR 3 ISSUE	CDye	AWoo	SCM
C01	16/06/21	SGAR 3 ISSUE	CDye	AWoo	SCM
P02	01/07/21	DCO ISSUE	CDye	AWoo	SCM
C02	01/07/21	DCO ISSUE	CDye	AWoo	SCM

DESIGNER  
**SWECO**

CONTRACTOR  
**GallifordTry**

CLIENT  
**highways england**

PROJECT TITLE  
**A47 WANSFORD TO SUTTON DUALLING**

PROJECT STAGE  
**PCF STAGE 3**

DRAWING TITLE  
**RIGHTS OF WAY AND ACCESS PLANS  
REGULATION 5(2)(k) and 5(2)(o)  
SHEET 5 OF 7**

SUITABILITY  
**AUTHORISED AS STAGE 3 COMPLETED**

SHEET SIZE	SCALE	STATUS	REVISION
A1	1:1250	A3	C02

DRAWING NUMBER  
**HE551494-GTY-HKF-000-DR-CH-31005**

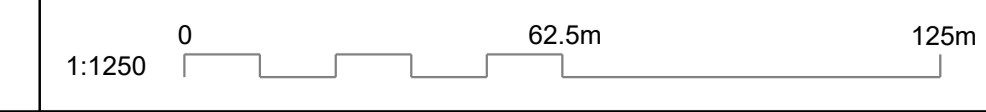

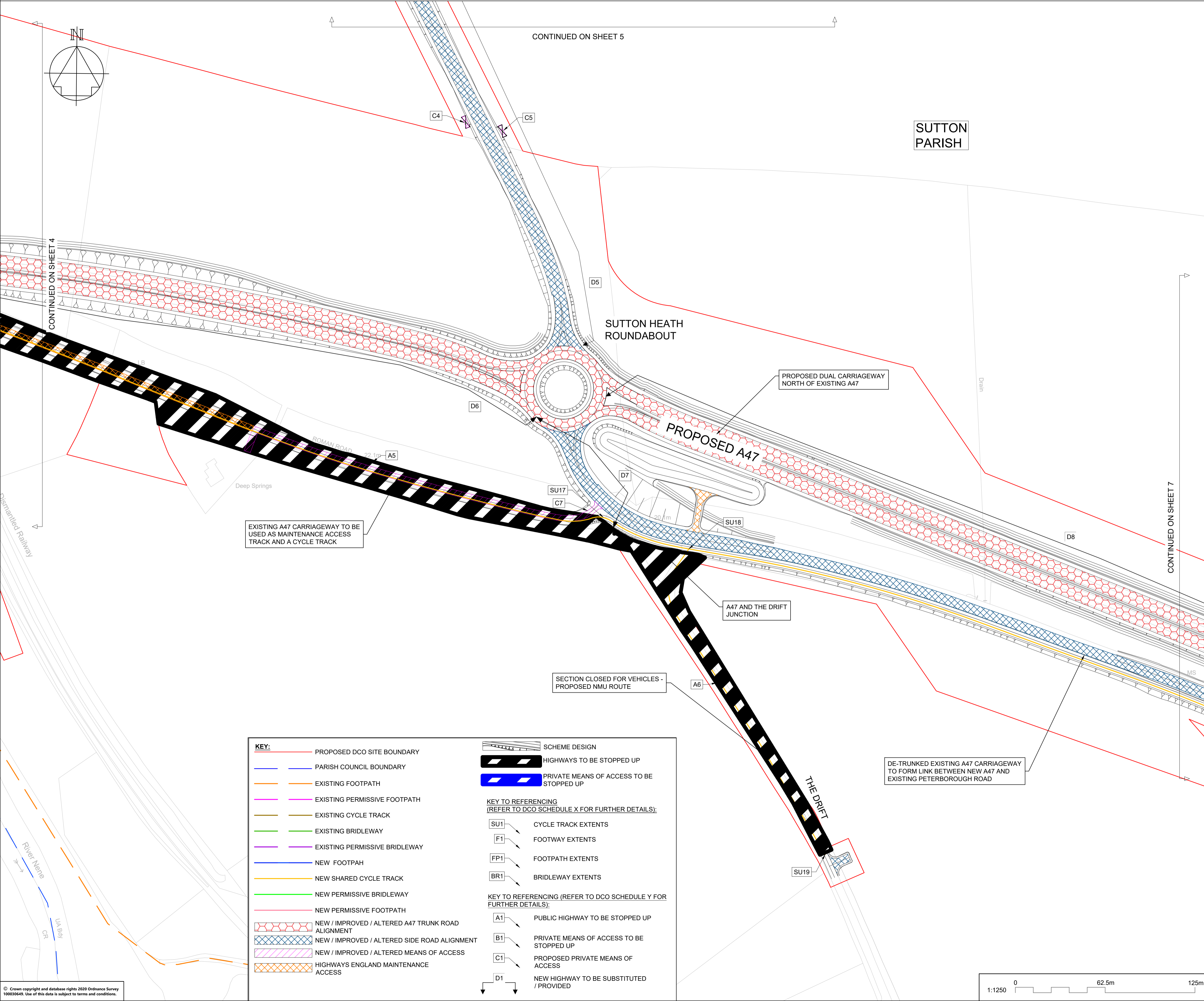

**KEY:**

- PROPOSED DCO SITE BOUNDARY
- PARISH COUNCIL BOUNDARY
- EXISTING FOOTPATH
- EXISTING PERMISSIVE FOOTPATH
- EXISTING CYCLE TRACK
- EXISTING BRIDLEWAY
- EXISTING PERMISSIVE BRIDLEWAY
- NEW FOOTPATH
- NEW SHARED CYCLE TRACK
- NEW PERMISSIVE BRIDLEWAY
- NEW PERMISSIVE FOOTPATH
- NEW / IMPROVED / ALTERED A47 TRUNK ROAD ALIGNMENT
- NEW / IMPROVED / ALTERED SIDE ROAD ALIGNMENT
- NEW / IMPROVED / ALTERED MEANS OF ACCESS
- HIGHWAYS ENGLAND MAINTENANCE ACCESS

**SCHEME DESIGN**

- HIGHWAYS TO BE STOPPED UP
- PRIVATE MEANS OF ACCESS TO BE STOPPED UP

**KEY TO REFERENCING (REFER TO DCO SCHEDULE X FOR FURTHER DETAILS):**

- SU1 CYCLE TRACK EXTENTS
- F1 FOOTWAY EXTENTS
- FP1 FOOTPATH EXTENTS
- BR1 BRIDLEWAY EXTENTS

**KEY TO REFERENCING (REFER TO DCO SCHEDULE Y FOR FURTHER DETAILS):**

- A1 PUBLIC HIGHWAY TO BE STOPPED UP
- B1 PRIVATE MEANS OF ACCESS TO BE STOPPED UP
- C1 PROPOSED PRIVATE MEANS OF ACCESS
- D1 NEW HIGHWAY TO BE SUBSTITUTED / PROVIDED

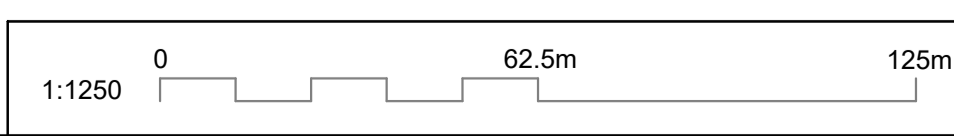

**NOTES**

Purpose of use  
**FOR DCO SUBMISSION**

Development Consent Order Number / Document  
**TR010039/APP/2.4**

**SHEET PLAN**

SHEETS 1 - 7 (INCLUDES INSETS 3A, 5B AND 7C)

- THESE PLANS SHOULD BE READ IN CONJUNCTION WITH OTHER PLANS AND DOCUMENTS IN THE DEVELOPMENT CONSENT ORDER.
- ALL DIMENSIONS ARE IN METRES UNLESS STATED OTHERWISE.

SEE PLAN FOR KEY

REV	DATE	REVISION NOTE	ORG	CHKD	APPD
P01	16/06/21	SGAR 3 ISSUE	CDye	AWoo	SCM
C01	16/06/21	SGAR 3 ISSUE	CDye	AWoo	SCM
P02	01/07/21	DCO ISSUE	CDye	AWoo	SCM
C02	01/07/21	DCO ISSUE	CDye	AWoo	SCM
P03	06/08/21	DCO UPDATE	CDye	AWoo	SCM

DESIGNER

**SWECO**

CONTRACTOR

**GallifordTry**

CLIENT

**highways england**

PROJECT TITLE

**A47 WANSFORD TO SUTTON DUALLING**

PROJECT STAGE

**PCF STAGE 3**

DRAWING TITLE

**RIGHTS OF WAY AND ACCESS PLANS  
REGULATIONS 5(2)(k) and 5(2)(o)  
SHEET 6 OF 7**

SUITABILITY

**SUITABLE FOR STAGE APPROVAL**

SHEET SIZE	SCALE	STATUS	REVISION
A1	1:1250	S4	P03

DRAWING NUMBER  
**HE551494-GTY-HKF-000-DR-CH-31006**

This drawing should not be relied on or used in circumstances other than those for which it was originally prepared and for which Sweco UK Ltd was commissioned. Sweco UK Ltd accepts no responsibility for this drawing to any party other than the person by whom it was commissioned. This drawing has been prepared on behalf of Galliford Try by Sweco UK Ltd for the titled project or named part thereof and should not be relied upon or used for any other project without an independent check being carried out as to its suitability and prior written authority of Galliford Try being obtained. Sweco UK Ltd accepts no responsibility or liability for the consequences of this drawing being used for a purpose other than the purposes for which it was commissioned. Any person using or relying on this drawing for such other purpose agrees, and will by such use or reliance be taken to confirm his/her agreement, to indemnify Sweco UK Ltd for all loss or damage resulting therefrom.

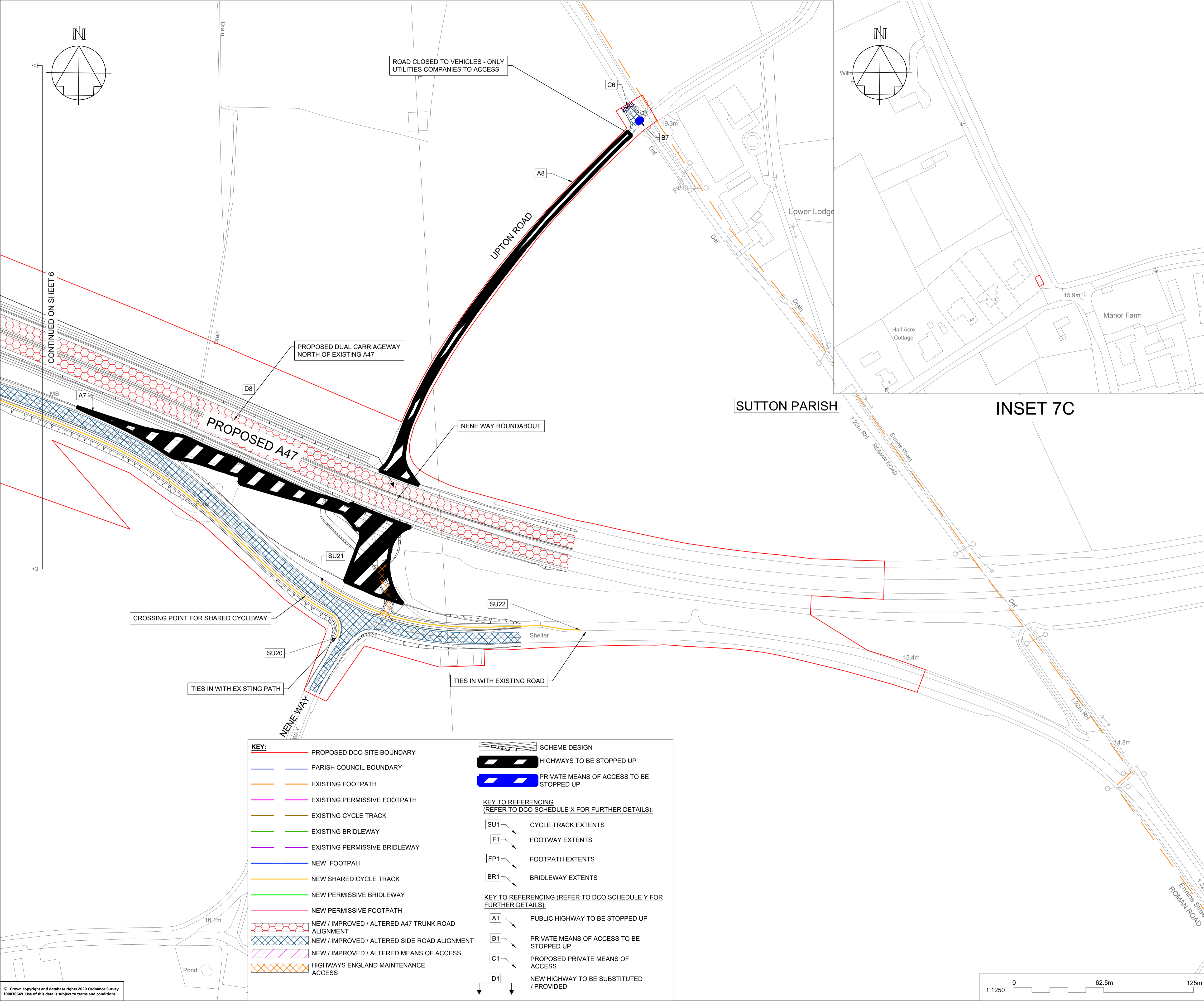

**NOTES**

Purpose of use  
**FOR DCO SUBMISSION**

Development Consent Order Number / Document  
**TR010039/APP/2.4**

**SHEET PLAN**

SHEETS 1 - 7 (INCLUDES INSETS 3A, 5B AND 7C)

WANSFORD RAILWAY UNDERPASS 5B

A47/A1 JUNCTION 3A

SACREWELL FARM UNDERBRIDGE 7C

NEW ROUNDABOUT 7

- THESE PLANS SHOULD BE READ IN CONJUNCTION WITH OTHER PLANS AND DOCUMENTS IN THE DEVELOPMENT CONSENT ORDER.
- ALL DIMENSIONS ARE IN METRES UNLESS STATED OTHERWISE.

SEE PLAN FOR KEY

REV	DATE	REVISION NOTE	ORG	CHKD	APPD
P01	16/06/21	SGAR 3 ISSUE	CDye	AWoo	SCM
C01	16/06/21	SGAR 3 ISSUE	CDye	AWoo	SCM
P02	01/07/21	DCO ISSUE	CDye	AWoo	SCM
C02	01/07/21	DCO ISSUE	CDye	AWoo	SCM

DESIGNER

**SWECO**

CONTRACTOR

**GallifordTry**

CLIENT

**highways england**

PROJECT TITLE

**A47 WANSFORD TO SUTTON DUALLING**

PROJECT STAGE

**PCF STAGE 3**

DRAWING TITLE

**PUBLIC RIGHTS OF WAY AND ACCESS PLANS REGULATIONS 5(2)(k) and 5(2)(o) SHEET 7 OF 7**

SUITABILITY

**AUTHORISED AS STAGE 3 COMPLETED**

SHEET SIZE	SCALE	STATUS	REVISION
A1	1:1250	A3	C02

DRAWING NUMBER

**HE551494-GTY-HKF-000-DR-CH-31007**

© Crown copyright and database rights 2020 Ordnance Survey 10003645. Use of this data is subject to terms and conditions.

**NOTES**

Purpose of use  
**FOR DCO SUBMISSION**

Development Consent Order Number / Document  
**TR010039/APP/2.4**

1. THESE PLANS SHOULD BE READ IN CONJUNCTION WITH OTHER PLANS AND DOCUMENTS IN THE DEVELOPMENT CONSENT ORDER.  
 2. ALL DIMENSIONS ARE IN METRES UNLESS STATED OTHERWISE.

**KEY TO SYMBOLS**

 ORDER LIMITS  
 SCHEME DESIGN

REV	DATE	REVISION NOTE	ORG	CHK'D	APP'D
P01	16/06/21	SGAR 3 ISSUE	CDye	AWoo	SCM
C01	16/06/21	SGAR 3 ISSUE	CDye	AWoo	SCM
P02	01/07/21	DCO ISSUE	CDye	AWoo	SCM
C02	01/07/21	DCO ISSUE	CDye	AWoo	SCM

DESIGNER



CONTRACTOR



CLIENT



PROJECT TITLE

**A47 WANSFORD TO SUTTON DUALLING**

PROJECT STAGE

**PCF STAGE 3**

DRAWING TITLE

**PUBLIC RIGHTS OF WAY AND ACCESS PLANS  
 REGULATIONS 5(2)(k) and 5(2)(o)  
 KEY PLAN**

SUITABILITY

**AUTHORISED AS STAGE 3 COMPLETED**

SHEET SIZE	SCALE	STATUS	REVISION
A1	1:10000	A3	C02

DRAWING NUMBER

**HE551494-GTY-HKF-000-DR-CH-31008**

